

VILLAGE OF COWLEY
 Ptn's Of SW 15, NW 15, NE 16, SE 21
 All Of SW 21 In Twp 7, Rge 1, W5M

----- VILLAGE BOUNDARY

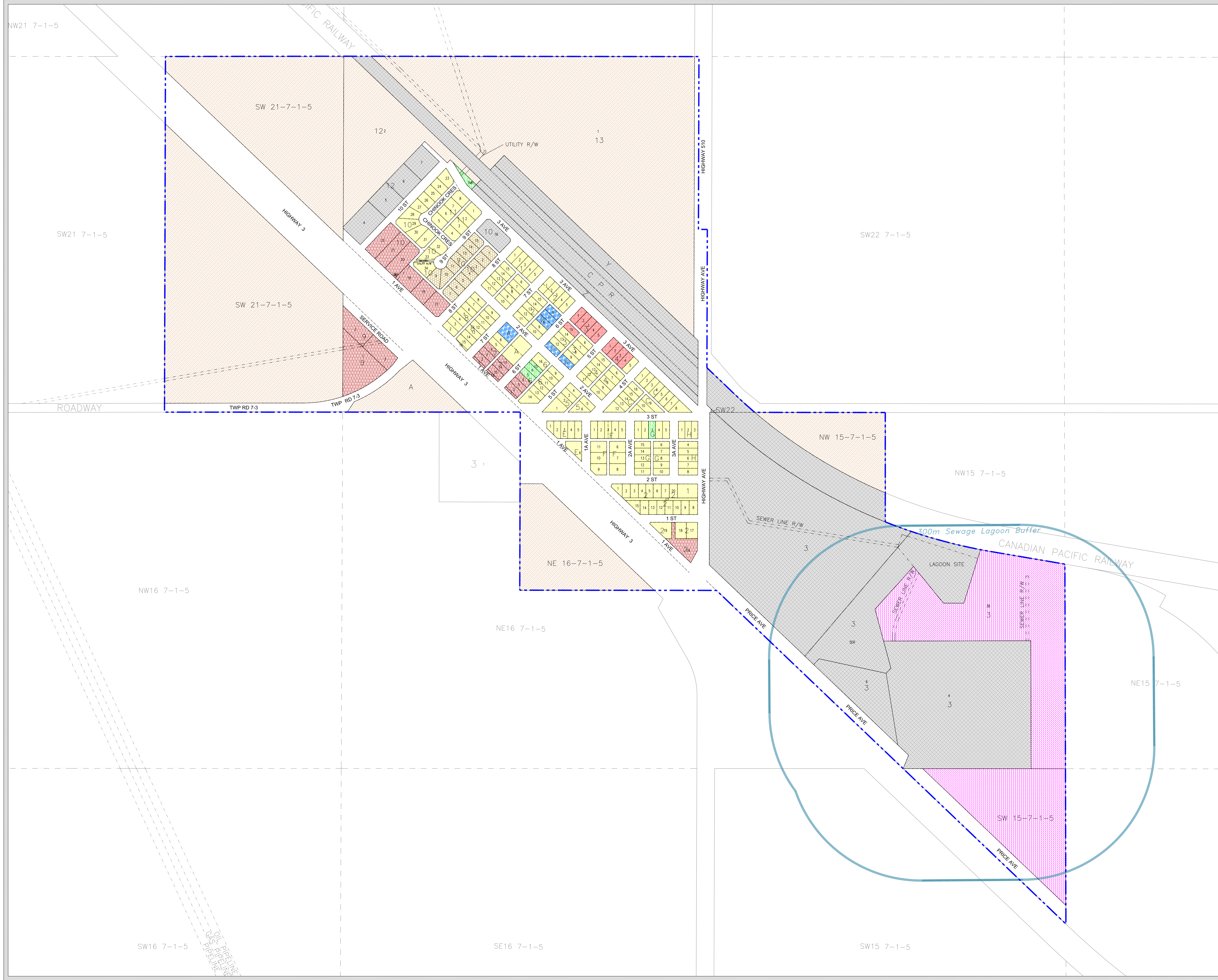

VILLAGE OF COWLEY
LAND USE DISTRICTS
 BYLAW NO. 352
 DATE: SEPTEMBER 15, 1998
 (UPDATED AS OF NOVEMBER 1, 2018)

| | | |
|--|------------------------------------|-----|
| | General Residential | R1 |
| | Mobile Home Residential | R2 |
| | Downtown/Retail Commercial | C1 |
| | Highway And General Commercial | C2 |
| | General Industrial And Warehousing | I |
| | Parks And Open Space | POS |
| | Public And Institutional | PI |
| | Transitional/Urban Reserve | TUR |
| | Direct Control | DC |

MAP PREPARED BY:
 OLDMAN RIVER REGIONAL SERVICES COMMISSION
 3105 16th AVENUE NORTH, LETHBRIDGE, ALBERTA T1H 5E8
 TEL. 403-329-1344
 NOT RESPONSIBLE FOR ERRORS OR OMISSIONS

